

— 1871 —
BARRELHOUSE
THE VENUE



info@BarrelhouseTheVenue.com

www.BarrelhouseTheVenue.com

219-243-7184

WHAT DOES MY RENTAL INCLUDE?

THE SPACE

- Seating for up to 200 guests, capacity of 300
- 21 custom-made tables
- Outdoor patio lined with whiskey barrels (weather permitting)
- Spacious private suite, furnished with couch, table and chairs
- 4 high-top tables
- Dimmable lights throughout
- String lighting
- Parking lot with ADA accessibility, overflow lot & street parking

PLANNING

- 1-Hour rehearsal with an on-site ceremony
- 1-Hour layout curation meeting ~30 days before your date
- Table/ chair set up included
- Security guard coordination - we'll schedule them for you! (Security to be paid directly, as a separate vendor)

DAY OF

- A Barrelhouse Associate will be on-site 1-hour before your ceremony until the dancefloor is in full swing
- Entire space for 12-14 hours (date dependent) starting at 10 AM

ADDITIONAL SERVICES

DAY OF COORDINATOR

Our Day of Coordinator is here to give you peace of mind that all the small details will be taken care of which will allow you to be present on your special day.

Ask for the “Day of Coordinator Duty List”

DECOR PACKAGES WITH SET UP

Basic Package - Each guest table includes a white or red table runner, 2 gold specked votives, and tri-tier floating candles in vases.

Premium Package - Each guest table includes all items in Basic Package, a white or red table runner, 2 gold specked votives, and tri-tier floating candles in vases plus 2 flameless taper candles in gold holders enclosed in hurricane glass.

Best of all, these items are set up and ready for you, upon arrival!

ADDITIONAL HOURS

You can add on up to 2 hours to use to get into the venue early on your date.

(8 AM CST is the earliest allowed arrival time)

Additional hours for rehearsal can be purchased, as well.

Pricing and availability vary, please call or email us for more details!

ARCH WITH DRAPERY

Square, wooden arch with sheer ivory draping.

You're welcome to ask your florist to add floral design as well.

If used outdoor, arch will have weights covered with drapery, as well.

TULLE BOWS

Tulle bows placed on every other row of your aisleway, for an indoor ceremony only.

DECOR & TABLESCAPE SET UP

Hourly service, available upon request

SECURITY COORDINATION

On-site from bar open to venue close, 1 officer **required.**



BASIC DECOR PACKAGE



PREMIUM DECOR PACKAGE

Photo includes floral design by J+K Flower Co. and tableware by Classic Catering, both not included with this package. If interested in that add on, let us know!



TULLE BOWS FOR INDOOR CEREMONY



ARCH WITH DRAPERY

LAYOUT EXAMPLES

As a reminder, each event has a unique layout that we curate together 30 days before your Wedding date, with final RSVP's received.

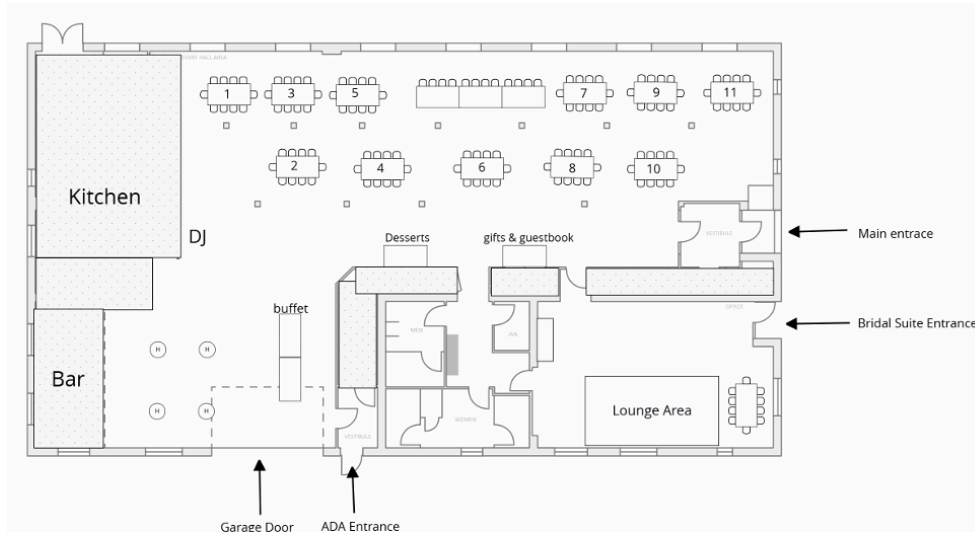

100 FARMHOUSE STYLE

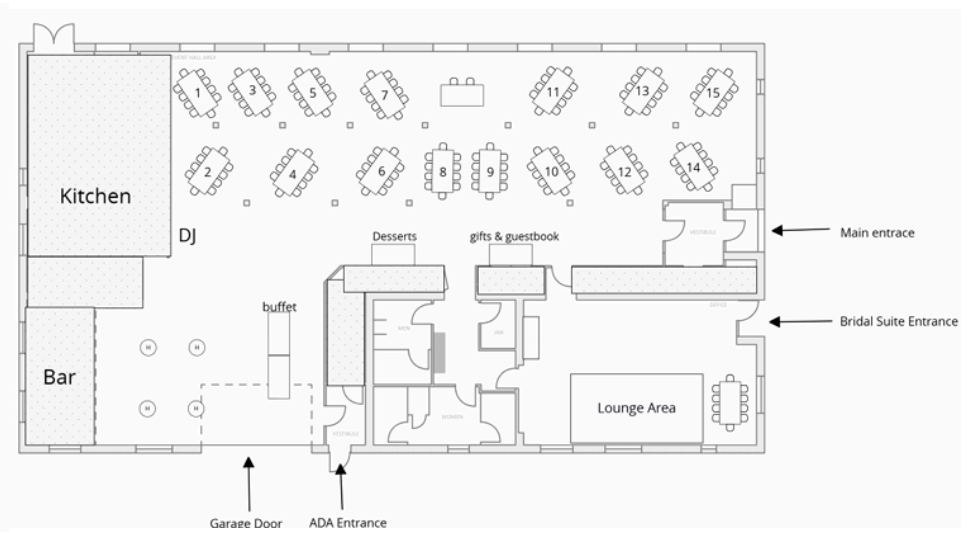

150 CHEVRON STYLE

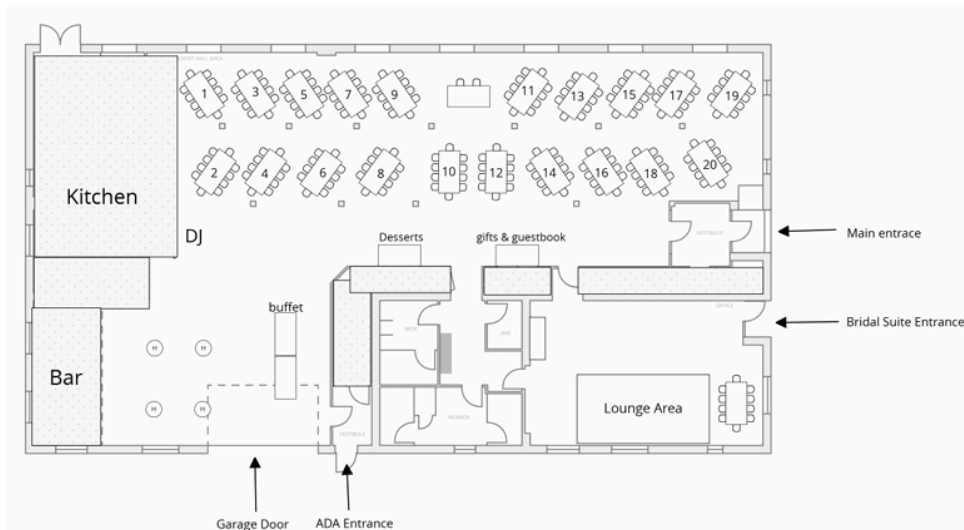

200 CHEVRON STYLE

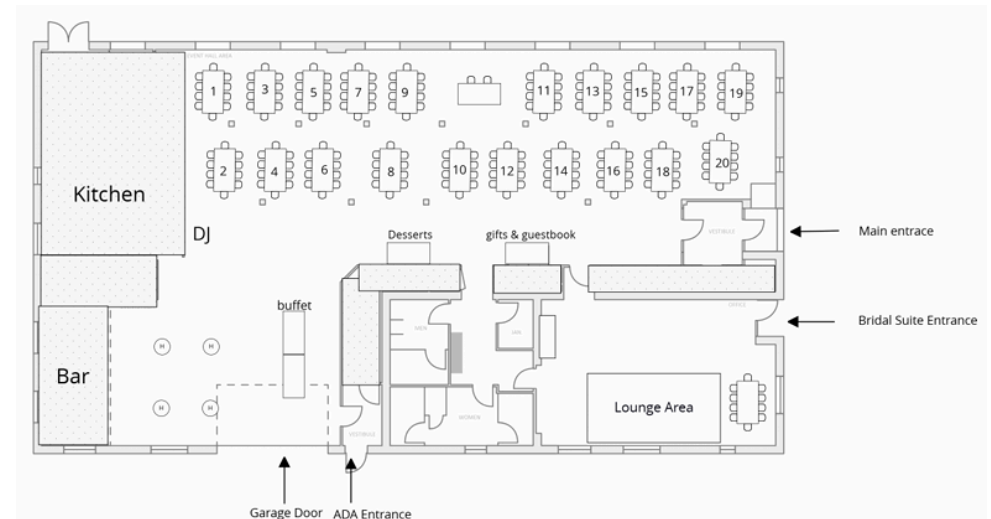

200 CAFETERIA STYLE

BOOKING YOUR DATE AT BARRELHOUSE THE VENUE

1. Receive a proposal from us, complete with contract and invoice
2. Sign your contract
3. Submit your Event Deposit
 - A 50% event deposit and signed contract is required to secure your date. The other 50% is due at least 30 days before your date. We offer flexible payment plan options - Ex. monthly payments
 - Payment options include:
 - Online ACH or Credit Card
 - Zelle (info@barrelhousethevenue.com)
 - Check to:

Barrelhouse The Venue
100 Anchor Road
Michigan City, IN 46360

4. Connect with your caterer
 - Classic Catering & Events is our exclusive catering partner. We'll put you in touch with them as soon as you book with us or by request, beforehand!
 - Book catering with them within 30-60 days of booking Barrelhouse The Venue.
5. Connect with your bar servicer
 - Zorn Brew Works is our exclusive bar servicer. We'll put you in touch with them as soon as you book with us or by request, beforehand!
6. If you're having an outdoor ceremony, choose your favorite chair options from Classic Catering. (At the very end of their menu and shown on their website, here: www.classiccateringevents.com/chairs)
 - Ensure they're offering same day set up/ tear down so you can take photos under the beautiful string lights after dusk!
7. Acquire your event liability insurance, required for all Weddings
 - Use **this link** to ensure the correct coverage is selected.

WHAT'S NEXT?



SCHEDULE AN
INTRO CALL HERE

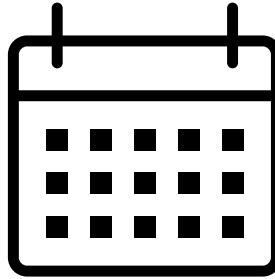

SCHEDULE A TOUR
HERE!

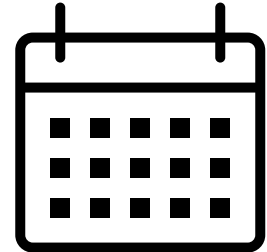

OR CALL 219-243-7184

CHECK OUT
OUR GALLERIES

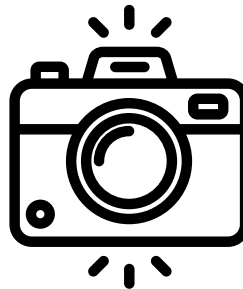

STAY IN TOUCH

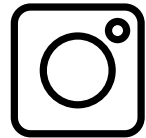

info@BarrelhouseTheVenue.com

www.BarrelhouseTheVenue.com

219-243-7184

*Bar pricing is subject to change due to fluctuations in market prices.

*Due to availability and or limitations any food or alcohol item may be substituted without notice.